

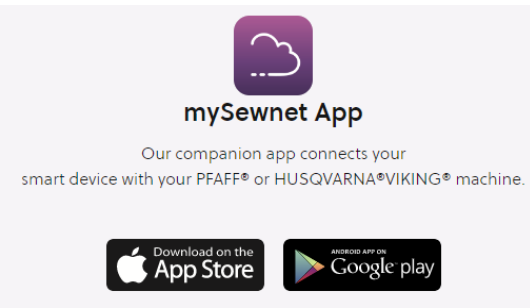

Levels: Basic/Silver/Gold/Platinum

Design Placement - with mySewnet App

Easily place embroidery design on the right fabric area. Simply take a photo of your hooped fabric with the app, send it to your mySewnet-enabled machine and use it as a background image to position the design.

<p>1.</p>	<p>mySewnet mobile app is an extension of the mySewnet experience. It offers creative features built for easy use. Leaving more time for fun and creativity.</p> <p>Go to App Store or Google Play to download it.</p>	 An advertisement for the mySewnet App. It features a purple square icon with a white cloud and three dots. Below the icon is the text 'mySewnet App'. Underneath that, it says 'Our companion app connects your smart device with your PFAFF® or HUSQVARNA®VIKING® machine.' At the bottom, there are two buttons: 'Download on the App Store' with the Apple logo and 'ANDROID APP ON Google play' with the Google Play logo.
-----------	------------------------------------------------------------------------------------------------------------------------------------------------------------------------------------------------------------------------	--------------------------------------------------------------------------------------------------------------------------------------------------------------------------------------------------------------------------------------------------------------------------------------------------------------------------------------------------------------------------------------------------------------------------------------------------------------------------------------------------------------------

2.

When you open the App you will have access to several different features.

In this instruction we will look at Design Placement

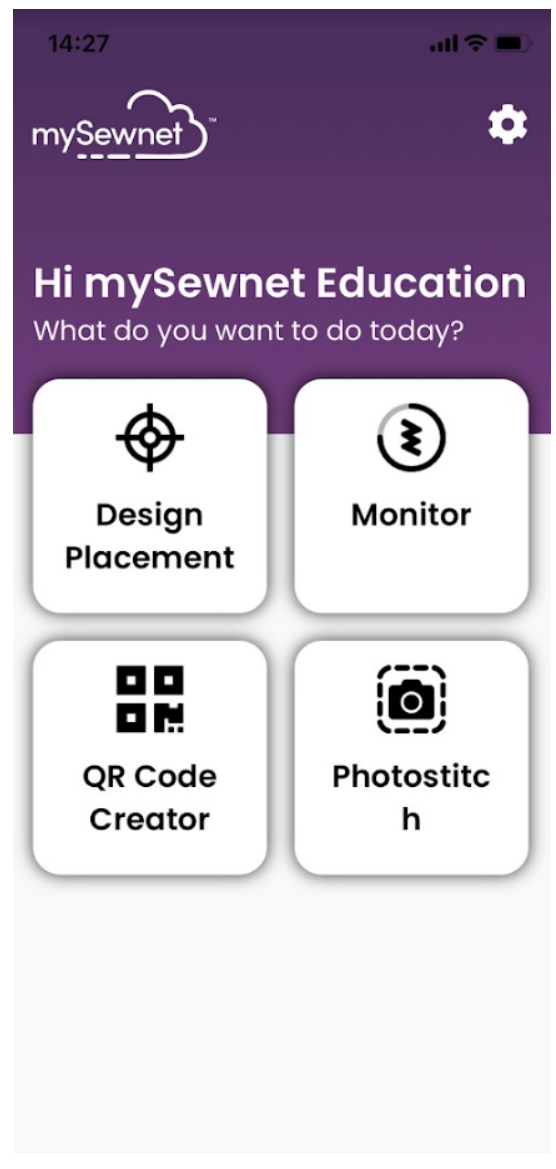

3.

When you open the Design Placement feature, you need to have a mySewnet-enabled machine connected to access the feature.

To see your machine in the list, make sure you are signed in with your mySewnet account in both the app and the machine.

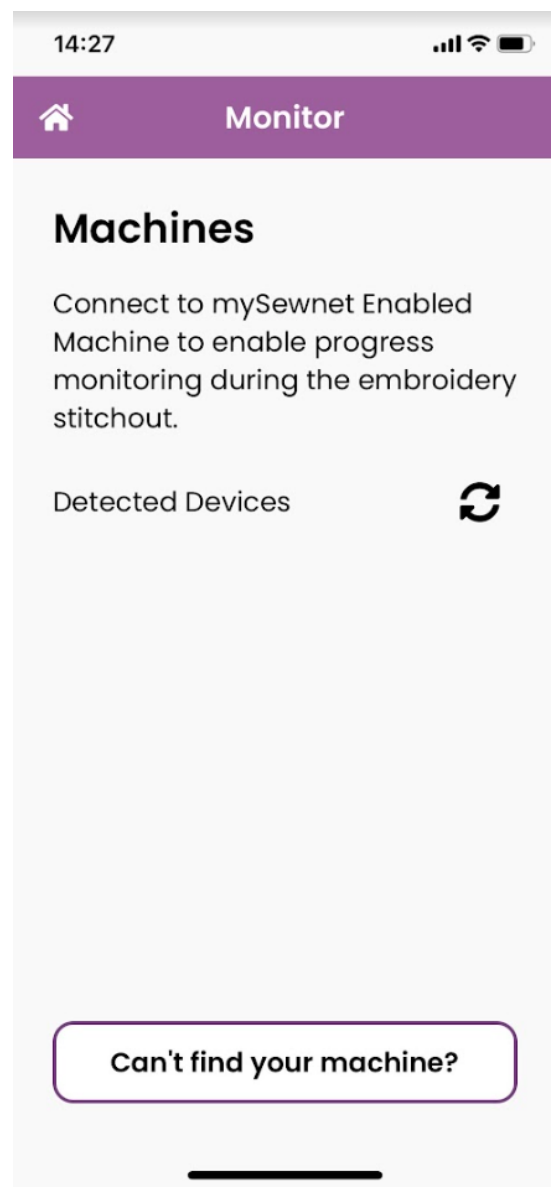

4.

Now you will be able to find your machine in the list of detected devices.

If you have several mySewnet-enabled machines that are connected, they will all be visible in the list.

Click on the machine you want to connect.

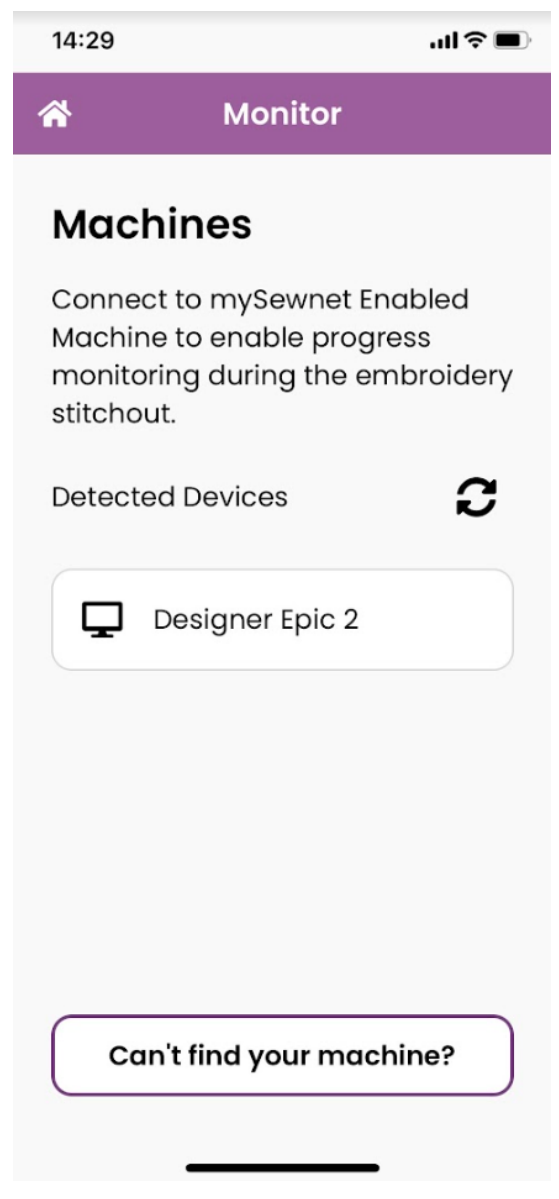

5.

This will open the camera on your phone/tablet.

Take a picture of your hooped fabric or project.

Click Use Photo



6.

Choose the correct hoop in the Select Hoop list



7.

If the app does not find the corners of your hoop correctly, click and drag on screen to place them where you need them to be.

The easiest way to get them correct is to make sure that the lines are matching the sides. The corners on the inner hoop is rounded and harder to find.

Click on the right arrow to continue to the next step

This is a preview of the image that will be sent to your machine.

Click on the Airplane to send it to your machine.

Now you can add the design you want to place on the hooped area either from the machine or sent from Library/Software

